

Air Velocity Transmitter Type A2G-20

WIKA Datasheet A2G-20

Applications

- For measuring air velocity and temperature in gaseous media of heating, ventilation and air-conditioning systems
- Building automation and process control systems
- Supply and exhaust fan tracking
- Clean room control systems

Special Features

- Simple installation
- High reliability
- Three air velocity ranges, one temperature range selectable by jumpers
- Two output signals in one instrument
- Comes standard with duct mounting flange

Standard Features

Design standards

EMC directive:	2004/108/EC
RoHS directive:	2002/95/EC
Low voltage directive:	2006/95/EC
WEEE directive:	2002/96/EC

Measuring ranges

Air velocity:
Measuring range 0...390 FPM (2 m/s), 0...1,970 FPM (10 m/s) and 0...3,940 FPM (20 m/s)
(Range selectable via jumper. Unit cannot be selected)
Temperature: +32...+122°F

Accuracy

Air velocity:
Measuring range 0 ... 390 FPM : < 19.6 FPM (±) 5% of measured value
Measuring range 0...1,970 FPM : < 98.1 FPM (±) 5% of measured value
Measuring range 0 ... 3,940 FPM : <196.2 FPM (±) 5% of measured value
Temperature: <0.5 °C (>1.2 °F)

air2guide



Air velocity transmitter Type A2G-20

Operating temperature

Ambient: +32 ... +122 °F
Storage: -4 ... +158 °F
Operation: +32 ... +122 °F, max. 85% rH

Ingress protection

IP 54 per EN 60529 / IEC 529 (NEMA 3)

Standard features

Measuring element

Pt1000 and NTC10k

Case

Plastic (ABS)

Electrical connection

PG-gland M16

Output signal

Air velocity:

0 ... 10 V (linear to FPM), load min. 1 kOhm or

4 ... 20 mA (linear to FPM), load max. 400 Ohm

Temperature:

0 ... 10 V (linear to °F), load min. 1 kOhm or

4 ... 20 mA (linear to °F), load max. 400 Ohm

Supply voltage

AC/DC 24 V $\pm 10\%$

Type of mounting

Duct installation

Standard accessories

Wiring diagram

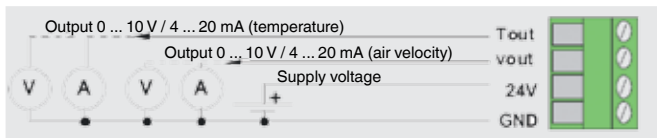

Mounting flange

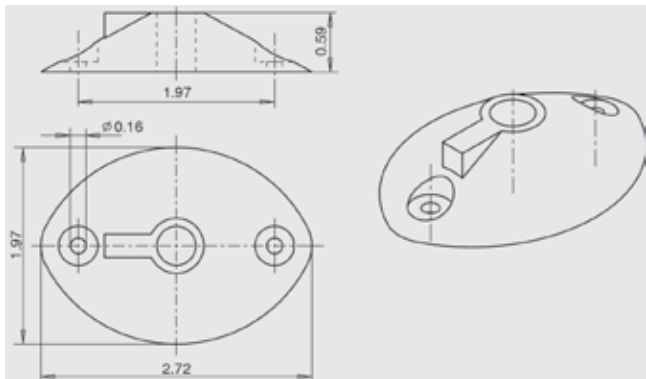

The specifications given in this document represent the state of engineering at the time of publishing. We reserve the right to make modifications to the specifications and materials.

Mounting flange

Options

- LC display for measured value display
- LC display for measured value display and relay (potential-free, change-over contact, max. AC 250 V, 6 A, DC 30 V, 6 A, adjustable switch point and hysteresis)

Dimensions in inches

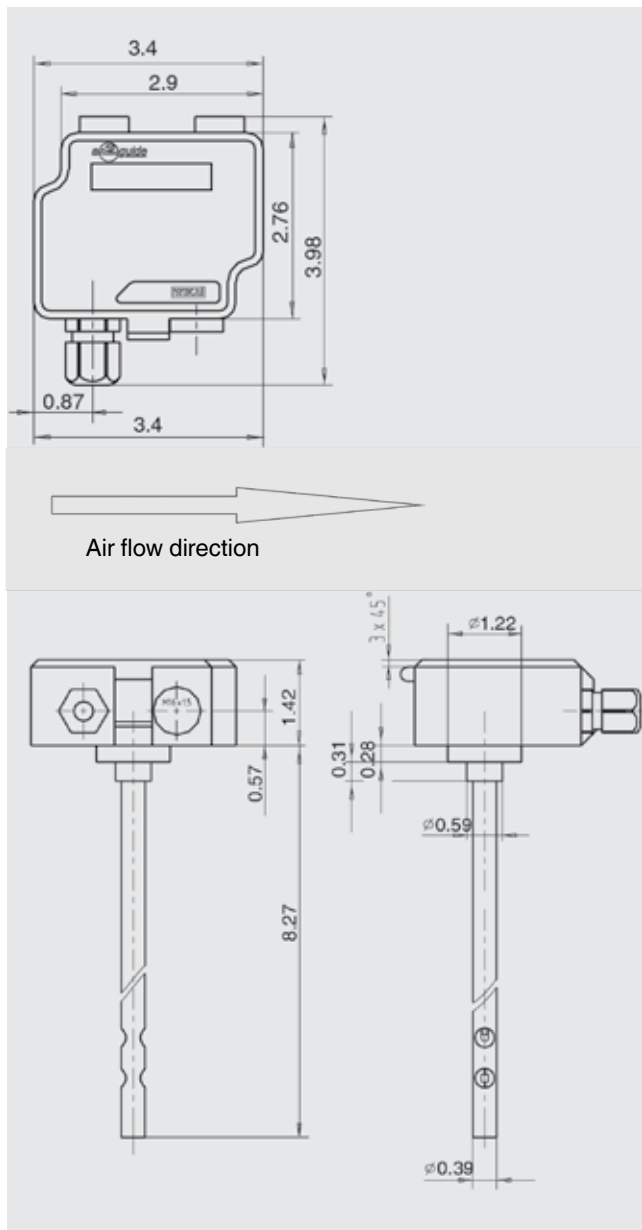

WIKAL Instrument, LP
1000 Wiegand Boulevard
Lawrenceville, GA 30043-5868
Tel: 888-WIKA-USA • 770-513-8200
Fax: 770-338-5118
E-Mail: info@wika.com
www.wika.com